



***UNITED IN  
HARMONY***

***NORTHERN LIGHTS REGION 6  
2020 CONVENTION***

**MAY 7 -10, 2020**

**HILTON ROCHESTER , DOUBLETREE  
HOTEL, AND MAYO CIVIC CENTER  
ROCHESTER, MN**

## CONTENTS

Announcements .....	3
Dates and Deadlines .....	4
Schedules of Events .....	5
General Convention Information .....	6-8
Saturday Night after Contest is Over .....	9
Order Form for Convention Program Ads .....	10
Competition Music Information .....	11
Guest Dinner Order Form .....	12
Registration Order Form .....	13-16
Housing Information .....	17
Housing Request Form .....	18
Room Assignment Form .....	19-20
Boutiques Table Rental Request .....	21
Chorus/Quartet Photo Order Form .....	22-25
Open Division Info .....	26
Quartet Cue Form (sample) .....	27
Chorus Cue Form (sample) .....	28
Regional Convention Committee .....	29

## CONVENTION HANDBOOK DISTRIBUTION

Chapter Presidents/Directors	Prospective Chapters
Regional Convention Committee	International Headquarters
Chapter-at-Large Members	Registered Quartets
Judging Panel	Regional Management Team



## MASS SING

Friday, May 8, 2020

12:30p.m.

### ***PEACE PLAZA***

The *Peace Plaza* is located in the heart of the city at

**1st Ave SW & 1st St SW.**

There is an enclosed shopping mall across from the Hilton accessible by street or skyway. Walk through the mall directly to the west out the entrance doors and you are in Peace Plaza

# Announcements

## QUARTET AND CHORUS BRIEFING AND CONTEST TIMES

The Quartet and Chorus Briefings will be held on Friday, May 8, 2020 at 8:30 a.m. in the Hilton

The Quartet Contest will begin at 7:00 p.m. on Friday, May 8, 2020 in the Mayo Civic Center.

The Chorus Contest will begin at noon on Saturday, May 9, 2020 in the Mayo Civic Center.

## CONVENTION REGISTRATION

Registration by **April 1, 2020—Deadline**

The all-events pass fee for the 2019 convention will be **\$150.00 for members** and non-member directors, **\$75.00 for YWIH members**, and **\$160.00 for non-member attendees**.

## QUESTIONS? - Who to contact

Hotel Registrations—**Nicole Ramaker**.  
507-529-2443.

Competition Questions (Music registration forms, Open Division cue forms, etc) -  
**Shirley Christie**  
P: 204-256-2265  
C: 204-794-2977  
smchris@shaw.ca

Registration Questions: **Jerralynn Tjeerdsma**  
C: 605-366-4793  
Email: jetjeerdsma@gmail.com

## MAKE MONEY!!! BOUTIQUE TABLES FOR RENT

Boutique tables will be available on a first come, first served basis, at a one time charge of **\$50 per table**. Limit ONE table, due to size of room. All proceeds are kept by the chorus or quartet. Send the form on page 21 to Finance Coordinator **Jerralynn Tjeerdsma** by April 1, 2020

## INDIVIDUAL EVENT TICKETS

Ticket will be on sale at the door one hour before each contest. Ticket prices are \$25 for adults and \$12 for students (age 15 and under).

# Dates and Deadlines

The Regional Convention Committee is providing the following checklist so choruses and quartets can keep track of deadlines. Please meet all deadlines to avoid late charges. Meeting deadlines will also ensure that you are able to compete if you so desire.

## REGIONAL DATES

### April 10, 2020

- Digital ready files (pdf or jpg) for convention program ads to Linda Rubis (page 10)
- Competition Music Information due to Linda Rubis (page 11)

### April 14, 2020

- Convention room reservations must be made online. See page 7 for online links for each hotel
- Links available on Region 6 website link—[www.regionsix.org](http://www.regionsix.org)
- **If you have a block of rooms reserved at the Hilton or DoubleTree rooming list must be submitted no later that APRIL 14, 2020**

### April 1, 2020

- Convention Registration submitted to Financial Coordinator,
  - Jerralynne Tjeerdsma - [jetjeerdsma@gmail.com](mailto:jetjeerdsma@gmail.com) (page 13)
  - **Late fee of \$15 per member (or guest) will be assessed on registrations postmarked April 1, 2020 or later.**

### April 1, 2020

- Guest form for Saturday Night Dinner due to Jerralynne Tjeerdsma (page 12)

### April 1, 2020

- Boutique Table Rental Request due to Jerralynne Tjeerdsma (page 21)

## INTERNATIONAL DATES

### January 24, 2020

- Emailing date for competition packets from International Headquarters. Non U.S. packets will be emailed two weeks prior to this deadline date.

### March 9, 2020

- Quartet registration and entry deadline (Quartet entry fee is \$100.00)

### March 10, 2020

- Chorus entry deadline. (Chorus entry fee is \$150.00)

### March 16, 2020

- Drawing for order of appearance. This order will be posted on the SAI website:  
[www.sweetadelineintl.org](http://www.sweetadelineintl.org)

### March 24, 2020

- Quartet late entry deadline.

### March 25, 2020

- Chorus late entry deadline

**IMPORTANT INFORMATION:** The paperwork for new and renewing quartets must be submitted and processed before they can register for competition. New quartets or renewal received after January 15, 2020 will be charged additional registration fees.

***The late fee of \$100.00, in addition to the entry fee is assessed to any quartet or chorus for which an entry blank is received at International Headquarters after the deadline dates listed above.*** The entry fee and late fees are nonrefundable and nontransferable.

# Schedule of Events

## Thursday, May 7, 2020

3:00—9:00 p.m.  
5:00— 10:00 p.m.  
6:00 - 8:00 p.m.

Registration/Information  
The Boutique  
Quartet Reception

Hilton - Franciscan Sisters Room  
Hilton - Franciscan Sisters Room  
Location - TBA

## Friday, May 8, 2020

8:30 a.m.—9:15 a.m.  
9:00 a.m.—4:40 p.m.  
9:00 a.m.—4:30 p.m.  
10:00 a.m. –10:45 a.m.  
12:30 p.m. - 1:00 p.m.  
1:30 p.m. – 5:00 p.m.  
  
11:00 a.m.—1:00 p.m.  
2:00 p.m.—3:00 p.m.  
6:45 p.m.  
7:00 p.m. -- 9:30 p.m.

Quartet/Chorus Briefing  
Registration/Information  
The Boutique  
Education Class - City of Lakes  
Mass Sing - Peace in Harmony  
Rochester Trolley Tour  
(See page 30-31 for details)  
Judges Inspection  
Leadership Meet and Greet  
Curtain Call  
Quartet Competition  
Announce Competition Results  
Pick up score sheets

Hilton - Mayo Doctors Hall 2  
Hilton - Franciscan Sisters Room  
Hilton - Franciscan Sisters Room  
Hilton - Mayo Doctors Hall 2  
Peace Plaza-1st Ave SW & 1st St. SW  
Pick up at Hilton Hotel Downtown  
  
Mayo Civic Center—Auditorium  
Hilton - Mayo Doctors Hall 1  
Mayo Civic Center—Auditorium  
Mayo Civic Center—Auditorium

## Saturday, May 9, 2020

7:00 a.m.—11:00 a.m.  
  
8:00 a.m.—10:00 a.m.  
9:30 a.m.—10:15 a.m.  
11:45 a.m.  
12:00 p.m.—4:30 p.m.

Chorus Rehearsals as assigned  
  
The Boutique  
City of Lakes Rehearsal  
Curtain Call  
Chorus Competition  
City of Lake Chorus Mini Show  
(2019 Champions)  
Announcement Competition Results  
Pick up score sheets  
  
5:30 p.m.  
6:00 p.m.  
8:00 p.m.  
Social Hour  
Celebration, Dinner, and Show  
Showcase and Afterglow

DoubleTree - University Hall I - IV  
and Chancellor  
Hilton - Franciscan Sisters Room  
Mayo Civic Center Auditorium  
Mayo Civic Center Auditorium  
Mayo Civic Center Auditorium  
Mayo Civic Center Auditorium  
  
Hilton - Franciscan Sisters  
Hilton - Doctors Mayo Hall  
Hilton - Doctors Mayo Hall

## Sunday, May 10, 2020

7:30 a.m.

Post-competition RCC Meeting

TBA

### 2020 OFFICIAL JUDGING PANEL

Expression & Panel Chair: Marcia Pinvidic  
Music: Sharon Babb  
Sound: Sandy Marron  
Showmanship: Lisa Greenough  
Panel Secretary: Liz Danielski

# General Convention Information

## STAGE

- All contestants will enter and exit the stage from the same side, Stage Right.
- No front curtain will be used during quartet or chorus competition.

## RISER CONFIGURATION

**We will be using the Alternate Riser configuration.**

## PHOTOGRAPHY

- Quartet pictures will be taken in the traffic pattern. Chorus pictures will be taken on stage.
- Plan your pose in advance.**
- The photo order forms are also available online at [www.readphotography.com](http://www.readphotography.com)**
- Turn your photo order in at Friday a.m. briefing. Please put order forms with payment in an envelope with your chorus or quartet name on the envelope.**

## MIDSIDE AND SMALL CHORUS AWARD ELIGIBILITY

The number for determining eligibility for these awards includes all singing members on stage at any given time, but does not include the director(s). The number turned in at the directors' briefing is the final number used by the panel secretary when determining which choruses meet the midsize and small size category criteria. To be eligible for these awards (in their category), they must attain 400 points or above.

A small chorus is classified as Division A with a minimum of 15 singing members and a maximum of 30 singing members on stage.

A midsize chorus is classified as Division AA with a minimum of 31 singing members and a maximum of 60 singing members on stage.

## CHAPTER-AT-LARGE MEMBERS

Four chapter-at-large members may form a quartet and compete at regional competition.

## SCORING

In the event of a tie in the total score between 2 or more contestants, the contestant receiving the highest total score in the SOUND category is awarded the higher placement. Remember, winners of all awards must score 400 points or above.

## WITHDRAWAL

If a chorus or quartet has to withdraw from contest, a written withdrawal notice must be received at International Headquarters. A phone call is not sufficient.

# General Convention Information

## REGISTRATION REGULATIONS

- All members and directors attending and or competing in the annual Regional Convention must pay the registration fee, as stipulated in the Region 6 Standing Rules.
- Non-members may purchase registration passes in advance through their local chorus for \$160.00. This pass includes admission to all events (including Saturday dinner), a name badge, program booklet.
- Name badges must be worn for admittance to convention events.

## **HOTEL RESERVATIONS: DEADLINE—April 14, 2020**

Register online via Rochester Convention Bureau website (Link below)

Hotel Registration Questions - Contact: Nichole Ramaker. 507-529-2443.

Links also available on [www.regionsix.org](http://www.regionsix.org) website.

### **Hilton:**

[https://www.hilton.com/en/hi/groups/personalized/R/RSTMAHH-SWE-20200506/index.jhtml?WT.mc\\_id=POG](https://www.hilton.com/en/hi/groups/personalized/R/RSTMAHH-SWE-20200506/index.jhtml?WT.mc_id=POG)

### **DoubleTree:**

[https://doubletree.hilton.com/en/dt/groups/personalized/R/RSTDTDT-SWE-20200506/index.jhtml?WT.mc\\_id=POG](https://doubletree.hilton.com/en/dt/groups/personalized/R/RSTDTDT-SWE-20200506/index.jhtml?WT.mc_id=POG)

The two hotels are within easy access to the Mayo Civic Center either outside or by enclosed walkway. The distance from the hotel via walkway is approximately 5 minutes. Hotels this year are: Hilton Rochester (Headquarters) and DoubleTree. See Page 17 for complete hotel information.

## CREDIT CARD

- Credit cards must be used when making room reservations (Use the form on page 18). Credit card information is required for each room.
- The hotel will need to see the credit card when you check in to guarantee payment of miscellaneous charges.
- The person who provides the credit card number must be the person who check in at the hotel. Use only one credit card per room.

## EDUCATION CLASS

An education class will be offered by the 2019 Regional Championship Chorus, City of Lakes Chorus, on Friday, May 8, 2019 at 10:00 a.m. in the Hilton Mayo Doctors Hall. This class is open to all members of Region 6

## SCORES ON-LINE

International continues to post on-line all medalists and their scores, including midsize chorus, small chorus and most improved chorus.

## INDIVIDUAL TICKET SALES

Tickets will be on sales at the door one hour before each contest. Ticket prices are \$25 for adults and \$12 for students (age 15 and under) for each contest.

# General Convention Information

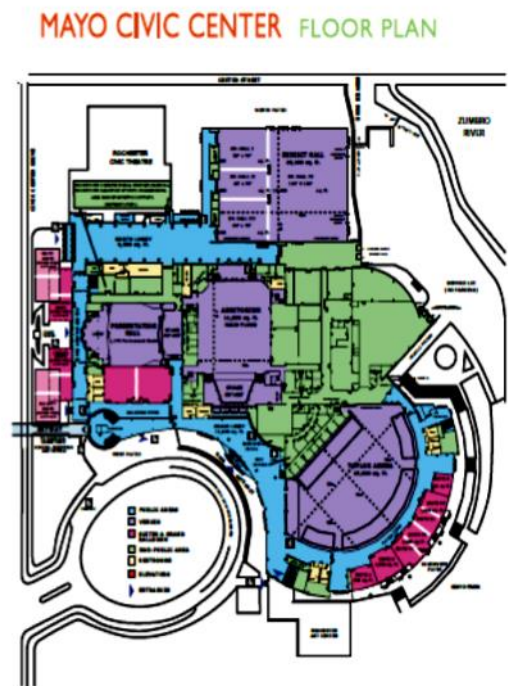
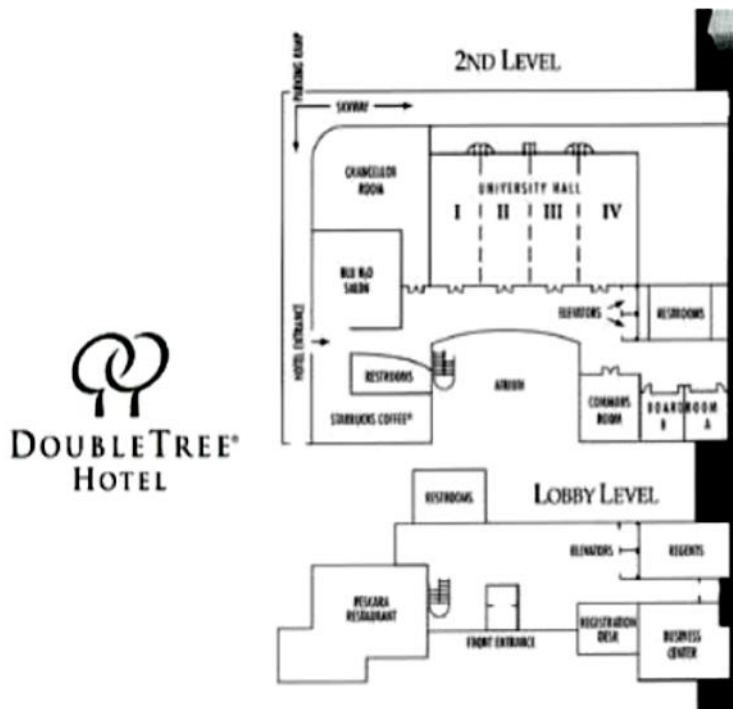

## BOUTIQUE TABLES FOR RENT

Boutique tables will be available on a first come, first served basis, at a one time charge of \$50 per table. All proceeds are kept by the chorus or quartet. Send the form on page 21 to Jerralynne Tjeerdsma April 1, 2020

## CONVENTION PROGRAM ADS

- Ads will be accepted for publication in the convention program until April 10, 2020.
- All ads must be submitted as digital print ready files (jpg or pdf). Printed colored business card or other colored printed materials are not acceptable. Photocopies don't produce well.
- Please submit ad in the proper orientation, horizontal or vertical as indicated below. So they will fit the page design.
- Prices are: horizontal business card size—\$20; Vertical quarter page—\$30; Horizontal half page—\$50; Vertical whole page—\$75. All prices are in US funds.
- Submit the form on page 10 and payment for the ad with the ad copy.



# Saturday Night After Contest Is Over

## REGIONAL CELEBRATION, DINNER, and SHOWCASE

featuring our 1st through 3rd place quartets and choruses.

**More singing at the Afterglow following the Showcase. All Choruses and Quartets are invited to sing. *Cake and desserts will be served to celebrate the 75th Anniversary of Sweet Adelines International.***

This is a time for all of us to be together for a great meal, visit with regional friends, and enjoy the show. Held in the Hilton Rochester Mayo Doctors Hall with Social Hour at 5:30 p.m. in the Franciscan Sisters Room. and dinner at 6:30 p.m.

The Showcase and Celebration will be held in the same room at the dinner, Hilton Mayo Doctors Hall. beginning at 8:00p.m. Limited individual guest tickets are available for purchase for the dinner. The dinner is included in the member and non-member registration pass fee. There are NO RESERVED TABLES for choruses and quartets and no table assignments. **(Please do not tip chairs to save tables (it is a hazard to attendees and hotel staff)).**

### LEVEL 4 – Doctors Mayo Hall

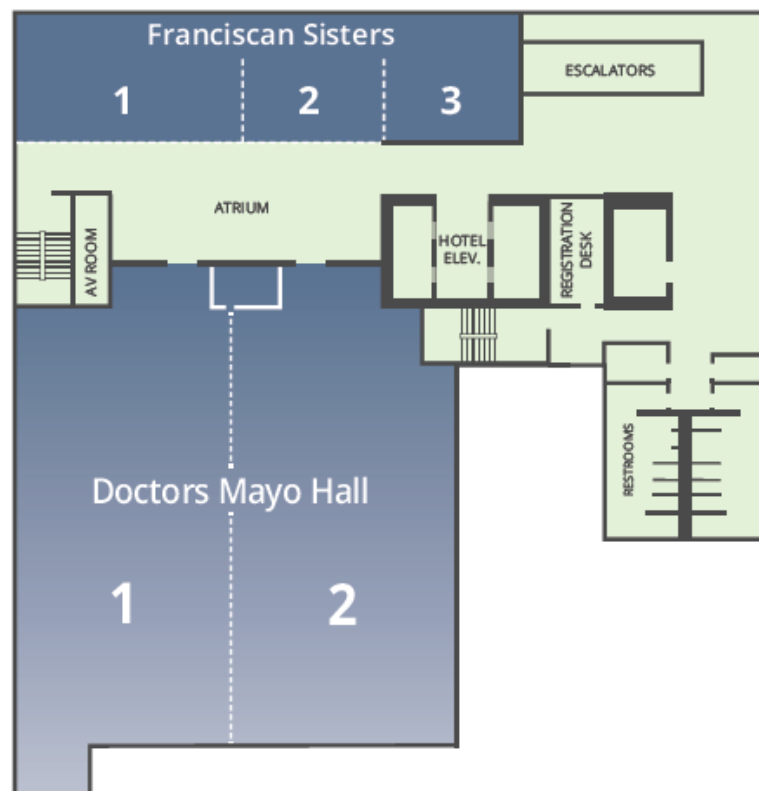

**DEADLINE: April 10, 2020**

## Order Form for Convention Program Ads

Contact \_\_\_\_\_

Address \_\_\_\_\_

City \_\_\_\_\_ State/Province \_\_\_\_\_ Zip/Post Code \_\_\_\_\_

Telephone \_\_\_\_\_ Email \_\_\_\_\_

Chorus/Quartet Business Name \_\_\_\_\_

Please submit ads in the proper orientation, horizontal or vertical as indicated below, so they will fit the page design. Check the size of the ad your are submitting (*measurements are wide by tall*)

- Horizontal Business Card (3.5" x 2") @ \$20.00

- Vertical Quarter Page (2.5" x 4.25") @ \$30.00

- Horizontal Half Page (5" x 4") \$50.00

- Vertical Whole Page (5" x 8") @ \$75.00

- A check in US funds made out to Region 6 must accompany this form.

- All ad copy must be digital print ready (pdf or jpg). Photocopies will not be accepted.

- Email ad to Linda Rubis at lrubis07@Q.com (no files larger than 9 MB).

- If you have questions about your ad or artwork, please contact Linda Rubis before submitting the ad at (712-336-4765) or lrubis07@Q.com

- Send this form and your check (payable to Region 6) to:

Linda Rubis  
2107 Gary Avenue  
Spirit Lake, IA 51360  
USA

- Email your ad to:

lrubis07@Q.com by April 10, 2020

**DEADLINE: April 10, 2020**

**DEADLINE: April 10, 2020**

## Regional Competition Music Information

ALL QUARTET AND CHORUS CONTESTANTS ARE REQUIRED TO COMPLETE THIS FORM

- It is your responsibility to get permission from the arranger to use the music.
- All music must have cleared the copyright process. Failure to use cleared arrangements may result in disqualification. International headquarters will be responsible for administering the copyright policies and procedures. Please refer all questions and/or comments to the Director of Music Services, [music@sweetadelines.com](mailto:music@sweetadelines.com) for handling.
- Print legibly please (using black ink) or type when filling out this form.
- Check your information carefully. How you submit it is how it will appear in the program
- You don't have to perform your songs in the order you list the. They WILL be printed in the convention program in the order you list them.
- **If songs are not submitted by April 10, 2020, they may not be listed in the program. It is the responsibility of the chorus or quartet to submit this information by the deadline.**

Quartet/Chorus Name: (Print) \_\_\_\_\_

1. Song Title (Print) \_\_\_\_\_

Arranger: (Print) \_\_\_\_\_

2. Song Title (Print) \_\_\_\_\_

Arranger: (Print) \_\_\_\_\_

For Choruses only: President: (Print) \_\_\_\_\_

Director: (Print) \_\_\_\_\_

For Quartets only: Tenor \_\_\_\_\_ Chapter \_\_\_\_\_

Lead \_\_\_\_\_ Chapter \_\_\_\_\_

Baritone \_\_\_\_\_ Chapter \_\_\_\_\_

Bass \_\_\_\_\_ Chapter \_\_\_\_\_

Submitted by: Name: (Print) \_\_\_\_\_

Telephone \_\_\_\_\_ Email \_\_\_\_\_

Note: Because of printing deadlines, last minutes changes may not be include in the program.

Send this completed form to:

Linda Rubis  
2107 Gary Avenue  
Spirit Lake, IA 51360

Or email it to: [lrubis07@Q.com](mailto:lrubis07@Q.com)

**DEADLINE April 10, 2020**

**DEADLINE: April 1, 2020**

## GUEST Dinner Order Form

- Use this form to order dinners for guest who are not purchasing registration passes.
- Please type or print in black ink.
- Dinners are \$50.00 (US funds) - Includes post dinner regional celebrations.
- Guest dinners will be reserved on a first come, first served basis.
- There will be no dinner tickets available at the door.

Chorus contact \_\_\_\_\_

Address \_\_\_\_\_

City \_\_\_\_\_ State/Province \_\_\_\_\_ Zip/Postal Code \_\_\_\_\_

Telephone \_\_\_\_\_ Email \_\_\_\_\_

Dinner includes: salad, one entrée and dessert

Entrée choices are:

Please indicate the number for your dinner choices

\_\_\_\_\_ Chicken Breast, topped with Roma Tomatoes, Fresh Mozzarella and Pesto Cream

\_\_\_\_\_ Roasted Garlic Thyme Crusted Prime Rib

\_\_\_\_\_ Three Cheese Ravioli, with Basil Cream and Garden Vegetables

Total number of Guest dinners @ \$50.00 \_\_\_\_\_ = \$ \_\_\_\_\_ (US Funds)

Total \_\_\_\_\_

Submit this form (**along with a check made payable to Region 6**) by **April 1, 2020** to:

Jerralyn Tjeerdsma  
1300 E. Northstar Lane  
Sioux Falls, SD 57108-4786  
jetjeerdsma@gmail.com

# DEADLINE: April 1, 2020

## Convention Registration Form

*ALL MEMBERS OF SWEET ADELINES INTERNATIONAL AND DIRECTORS, COMPETING OR NOT, ARE REQUIRED TO PURCHASE REGISTRATION PASSES.*

- Check your spelling carefully as it will be used to create name badges.
- Indicate first time attendees with a star \* behind their names.
- Indicate YWIIH with YWIIH behind their names.
- Indicate non-member guests by writing "G" after their names.
- Registration passes are transferable, but not refundable.
- Only ONE PERSON from each chorus or quartet will be allowed to pick up the registration packet for the chorus or quartet on Thursday or Friday. Registration will not be open on Saturday.

Chorus/Quartet Name: (Print or Type) \_\_\_\_\_

Contact Name: (Print or Type) \_\_\_\_\_

Phone # \_\_\_\_\_

Number of member passes @ \$150.00/member \_\_\_\_\_ = \$ \_\_\_\_\_ (US funds)

Number of non-member passes @ \$160.00/person \_\_\_\_\_ = \$ \_\_\_\_\_ (US funds)

YWIIH member passes @ \$75.00/member \_\_\_\_\_ = \$ \_\_\_\_\_ (US funds)

Late fee after April 5, 2019 @ \$15.00/person \_\_\_\_\_ = \$ \_\_\_\_\_ (US funds)

**TOTAL \$** \_\_\_\_\_

**NAME AND SAI MEMBER NUMBER.** Indicate First Time Attendees (\*) and non-member guests (G) and YWIIH (YWIIH)

	First	Last	SAI Number	First Time (*) Guest (G) YWIIH (YWIIH)	Fee Amount (\$) US Dollars
1					
2					
3					
4					
5					
6					
7					
8					
9					
10					
11					
12					
13					
14					
15					
16					
17					

**Must arrive by deadline of April 1, 2020**

19					
20					
21					
22					
23					
24					
25					
26					
27					
28					
29					
30					
31					
32					
33					
34					
35					
36					
37					
38					
39					
40					
41					
42					
43					
44					
45					
46					
47					
48					
49					
50					
51					
52					
53					
54					
55					
56					
57					
58					
59					
60					
61					
62					
63					
64					
65					

**Must arrive by deadline of April 1, 2020**

66					
67					
68					
69					
70					
71					
72					
73					
74					
75					
76					
77					
78					
79					
80					
81					
82					
83					
84					
85					
86					
87					
88					
89					
90					
91					
92					
93					
94					
95					
96					
97					
98					
99					
100					
101					
102					
103					
104					
105					
106					
107					
108					
109					
110					
111					
112					

**Must arrive by deadline of April 1, 2020**

113					
114					
115					
116					
117					
118					
119					
120					
121					
122					
123					
124					
125					
126					
127					
128					
129					
130					
131					
132					

<b>Total</b>	\$	-
--------------	----	---

**Please indicate the quantity for your dinner choices**

\_\_\_\_\_ Chicken Breast, topped with Roma Tomatoes, Fresh Mozzarella and Pesto Cream

\_\_\_\_\_ Roasted Garlic Thyme Crusted Prime Rib

\_\_\_\_\_ Three Cheese Ravioli, with Basil Cream and Garden Vegetables

**Save file to your computer and rename with your chorus or quartet name:**

***Make 2 Copies: 1 copy for your file, 1 copy to send in mail with check made payable to Region 6.***

**ALSO: Email a copy to Jerralynn Tjeerdsma at: [jetjeerdsma@gmail.com](mailto:jetjeerdsma@gmail.com)**

**and to: Shannon Cook at: [prairiepen@ndsupernet.com](mailto:prairiepen@ndsupernet.com);**

Jerralynn Tjeerdsma  
1300 E. Northstar Lane  
Sioux Falls, SD 57108

**Must arrive by DEADLINE of April 1, 2020**



**DEADLINE: April 14, 2020**

## Convention Housing Information and Deadlines

The Headquarters hotel is the Hilton Rochester Mayo Clinic Area. Contest will be held at the Mayo Civic Center. Dinner and the Celebration Showcase will be held at the Hilton. Contestants will be bussed to the Center. There will be an audience bus. The hotel is within easy access to the Mayo Civic Center either outside or by enclosed walkway. The distance from the hotel via walkway is approximately 5 minutes.

### **Hilton Rochester**

Room Rate—\$179.00 (Plus tax) Standard room - 1 King or Two Queen Beds

[https://www.hilton.com/en/hi/groups/personalized/R/RSTMAHH-SWE-20200506/index.jhtml?WT.mc\\_id=POG](https://www.hilton.com/en/hi/groups/personalized/R/RSTMAHH-SWE-20200506/index.jhtml?WT.mc_id=POG)

<u>Group Name:</u>	Northern Lights Region 6 Sweet Adelines International Convention
<u>Group Code:</u>	SWE
<u>Check-In:</u>	06-MAY-2020
<u>Check-Out:</u>	10-MAY-2020
<u>Hotel Name:</u>	HILTON ROCHESTER MAYO CLINIC AREA
<u>Hotel Address:</u>	10 East Center Street Rochester, Minnesota 55904
<u>Phone:</u>	507-258-5757

### **DoubleTree by Hilton Hotel Rochester**

Room Rate —\$139.00 (Plus tax) Standard room - 1 King or Two Full Beds

[https://doubletree.hilton.com/en/dt/groups/personalized/R/RSTDSTD-SWE-20200506/index.jhtml?WT.mc\\_id=POG](https://doubletree.hilton.com/en/dt/groups/personalized/R/RSTDSTD-SWE-20200506/index.jhtml?WT.mc_id=POG)

<u>Group Name:</u>	Northern Lights Region 6 Sweet Adelines International Convention
<u>Group Code:</u>	SWE
<u>Check-In:</u>	06-MAY-2020
<u>Check-Out:</u>	10-MAY-2020
<u>Hotel Name:</u>	DoubleTree by Hilton Hotel Rochester - MAYO CLINIC AREA
<u>Hotel Address:</u>	150 South Broadway Rochester, Minnesota 55904
<u>Phone:</u>	507-281-8000

### **Links available on the regionsix.org website.**

**Room rates do not include parking fees Parking in City Ramps \$8.00/Day per Car**

### **HOSPITALITY ROOMS/CHORUS BREAKFAST/LUNCH/REHEARSAL**

Hostility rooms or rooms for any chorus events must be reserved by contacting the hotel. The cost of the room will be the responsibility of the chorus.

### **CHECK-IN AND CHECK-OUT**

Check-in at the hotel is 3:00 p.m. with check-out at 12 noon. One credit card per room registering is required by the hotel to guarantee payment of miscellaneous charges. The credit card holder must be listed first in each room (See page 17-18—Convention Room Assignment Form)

### **DEADLINE**

**The registration must be made by April 14, 2020.** (see page 16—Convention Housing Request Form). No rooms will be held after this date. After this date you will be on your own to reserve rooms and the special convention rate may not be available. Credit card information must be complete for each room registering. **Changes or adjustments made after April 14, 2020 may not be accepted by the hotel.**

**DEADLINE: April 14, 2020**

**DEADLINE: April 14, 2020**

## **Convention Room Assignment Form**

- This form is to be used for your chorus/quartet and will be your guide to register online. Each room must have a credit card number to hold the room. Make additional copies as needed.
- Please provide the Individual Housing Form to the individuals in order to collect their confidential credit card information. Return the form to your competition coordinator.
- Complete the credit card information for the FIRST person listed for each room. This person will check in at the hotel and will present the credit card again to guarantee payment of miscellaneous charges.

Chorus/Quartet Name \_\_\_\_\_

**Names**

---

---

---

Thursday \_\_\_\_ Friday \_\_\_\_ Saturday \_\_\_\_  
\_\_\_\_ Handicapped accessible needed

**Names**

---

---

---

Thursday \_\_\_\_ Friday \_\_\_\_ Saturday \_\_\_\_  
\_\_\_\_ Handicapped accessible needed

**Names**

---

---

---

Thursday \_\_\_\_ Friday \_\_\_\_ Saturday \_\_\_\_  
\_\_\_\_ Handicapped accessible needed

**Names**

---

---

---

Thursday \_\_\_\_ Friday \_\_\_\_ Saturday \_\_\_\_  
\_\_\_\_ Handicapped accessible needed

**Names**

---

---

---

Thursday \_\_\_\_ Friday \_\_\_\_ Saturday \_\_\_\_  
\_\_\_\_ Handicapped accessible needed

**Names**

---

---

---

Thursday \_\_\_\_ Friday \_\_\_\_ Saturday \_\_\_\_  
\_\_\_\_ Handicapped accessible needed

**DEADLINE: April 14, 2020**

**DEADLINE: April 14, 2020**

**Northern Lights Region 6 Convention & Competition**

Individual Housing Form  
Rochester, MN - May 6 - 10, 2020

**Chorus Name:** \_\_\_\_\_

**THIS FORM IS FOR THE CHORUS/QUARTET HOUSING CONTACT USE ONLY. RETURN THIS FORM TO YOUR CHORUS OR QUARTET CONTEST COORDINATOR. THE FOLLOWING FORM CAN BE USED TO MAKE THE HOUSING RESERVATIONS VIA THE ONLINE RESERVATION SYSTEM.**

**Our chorus/quartet will be staying at:** Hilton Rochester \_\_\_\_\_ or DoubleTree Hotel \_\_\_\_\_

*The person listed as the #1 occupant is the room leader and should be the credit card holder for the room deposit.  
The room leader should not change once the reservation has been submitted.*

Indicate Rooming Dates	Wed	Thurs	Fri	Sat
	May 6, 2019	May 7, 2019	May 8, 2019	May 9, 2019

Room Type	1 - King	2 Beds	Jr. Suite

Special Accommodations? Example: Handicap Accessible \_\_\_\_\_

Arrival Day: \_\_\_\_\_

Departure Day: \_\_\_\_\_

Arrival Date: \_\_\_\_\_

Departure Date: \_\_\_\_\_

**Room Rate: DoubleTree**

Single and Double Occupancy Rooms - \$139.00 plus - 8.125% Sales Tax and 15.125% Occupancy  
*Doubletree standard rooms come with either one king bed OR two full beds.*

**Room Rate: Hilton Rochester (Headquarter Hotel)**

Single/Double Occupancy Rooms - \$179.00 plus - 8.125% Sales Tax and 15.25% Occupancy  
*Hilton standard rooms come with one king bed, or two queen beds.*

*There are some restrictions and extra fees involved if you request a cot. Some rooms are not allowed to have cots, because it violates our fire code.*

**Occupants:**

**Email Address:**

1. \_\_\_\_\_
2. \_\_\_\_\_
3. \_\_\_\_\_
4. \_\_\_\_\_

\_\_\_\_\_  
\_\_\_\_\_  
\_\_\_\_\_  
\_\_\_\_\_

Credit Card Information (Reservation cannot be process without this information.)

Type: \_\_\_\_\_ Card Number \_\_\_\_\_

Name on Card \_\_\_\_\_

Security Code \_\_\_\_\_ Expiration Date: \_\_\_\_\_

Billing Address: \_\_\_\_\_

Billing City, State Zip \_\_\_\_\_

**DEADLINE: April 14, 2020**

## Convention Housing Form

This form is to use for your chorus and will be your guide to registering online. Each room must have a credit card number to the hold room.

Register online at:

(Links are available on the regionsix.org website competition page.)

Chorus/Quartet Name \_\_\_\_\_

Contact \_\_\_\_\_

Address \_\_\_\_\_

City \_\_\_\_\_ State/Province \_\_\_\_\_ Zip/Post Code \_\_\_\_\_

Home Telephone \_\_\_\_\_ Work Phone \_\_\_\_\_

Email Address \_\_\_\_\_

Total number of rooms requested

\_\_\_\_\_ May 7, 2020

\_\_\_\_\_ May 8, 2020

\_\_\_\_\_ May 9, 2020

**DEADLINE: April 14, 2020**

**DEADLINE: April 1, 2020**

## **Boutique Table Rental Request**

- Any Region 6 member, quartet or chorus may rent one (1) table in the boutiques sales area. All tables will be rented on a first come, first served basis based on the postmark of your request.
- **A maximum of one table per request will be allowed.**
- A \$50 check (US Funds) made payable to Region 6 must accompany this form. If space is unavailable, your check will be returned.

Contact \_\_\_\_\_

Address \_\_\_\_\_

City \_\_\_\_\_ State/Province \_\_\_\_\_ Zip/Post Code \_\_\_\_\_

Home Telephone \_\_\_\_\_ Work Phone \_\_\_\_\_

Email Address \_\_\_\_\_

Provide a brief description of the item(s) you want to sell:

Submit this form (**along with a check for \$50.00 made payable to Region 6**)

**by April 1, 2020 to:**

Jerralyn Tjeerdsma  
1300 E. Northstar Lane  
Sioux Falls, SD 57108-4786  
jetjeerdsma@gmail.com

**Chorus & Quartet  
photo order forms  
on following pages.  
Please turn in at  
Friday a.m. briefing.**

**Please put order forms with payment in an envelope with  
your chorus or quartet name on the envelope.**

*Sweet Adelines Region 6*  
*2020: Rochester*

www.sweetadelines.com

*Read Photography*

ORDER FORM  
 (please print clearly)  
 www.readphotography.com

## **CUSTOMER INFORMATION**

\_\_\_\_\_  
 Contact Name

\_\_\_\_\_  
 Quartet/Chorus Name

\_\_\_\_\_  
 Shipping Address

\_\_\_\_\_  
 Semi-Finals/Finals

\_\_\_\_\_  
 City, State/Prov, Country, ZIP/PC

\_\_\_\_\_  
 Costume Description: Provide costume details, please  
 include more information than color.

\_\_\_\_\_  
 Daytime Phone

\_\_\_\_\_  
 Email Address

☐ CHECK THIS BOX IF YOU DO NOT WANT BORDER WITH TEXT/TITLE ON ALL YOUR PHOTOS

ALL photos will be available to order from our website approximately 4-6 weeks after convention.

\*All candids purchased from our online store will include the same border that is  
 printed on the images at the convention.\*

**VINYL BANNERS:** If interested in ordering a banner please inquire at our booth at the convention  
 OR  
 contact the studio (319) 393-0547.

SPECIAL QUARTET PACKAGES	INCLUDES	PRICE	QUANTITY	TOTAL
<b>A</b>	4- 8x10	\$60		
<b>B</b>	4- 8x10 1-PR Image	\$70		
<b>C</b>	4- 8x10 4- color wallets 1- PR Image	\$75		
<b>D</b>	4- 8x10 4- 4x5 1- PR Image	\$100		
<b>E</b>	4- 8x10 PR Candid Disc 1- PR Image	\$110		

\* These packages are for Quartets only

\*Please add total from here to  
 the last page and remember  
 to add shipping.\*

**PACKAGE SUBTOTAL:**

Page 1 of 3

INDIVIDUAL PRINTS: CHORUS & QUARTETS	PRICE	QUANTITY	TOTAL
2.5 x 3.5 Color Wallets (comes in quantities of 8)	\$10		
4 x 6 Color	\$7		
5 x 7 Color	\$13		
8 x 10 Color (ideal up to 30 members)	\$16		
11 x 14 Color (ideal up to 40 members)	\$20		
8 x 16 Color	\$22		
8 x 18 Color	\$25		
10 x 16 Color (ideal for 40-60 members)	\$22		
10 x 18 Color (ideal for larger choruses; 70+ members)	\$25		

\*Please add total from here to the last page and remember to add shipping.\*

**INDIVIDUAL PHOTO SUBTOTAL:**

## PR IMAGES

For publication purposes only; not to be used for personal reproduction.

When images are published they should be followed by the caption:

© Read Photography

A disc of all 4x6 candid images can be provided to a chorus or quartet.

The price for a PR disc depends on the amount of people in your chorus and ONLY INCLUDES ONE PERFORMANCE.

Posed photos ( Choruses onstage; or Quartet against photographic background) can also be purchased.

PR IMAGES	PRICE	QUANTITY	TOTAL
Posed Quartet or Chorus (only 1 image)	\$15		
Quartet Candids	\$50		
Chorus Candids: less than 41 members	\$50		
Chorus Candids: 41-70 members	\$75		
Chorus Candids: 70+ members	\$100		
Awards, Opening Ceremony- please specify below	\$100		

\*Please add total from here to the last page and remember to add shipping.\*

**PR IMAGE SUBTOTAL:**



# Sweet Adelines Region 6 2020: Rochester

www.sweetadelines.com

*Read Photography*

ORDER FORM  
(please print clearly)  
www.readphotography.com

## ONSTAGE PHOTOS:

When ordering onstage chorus photos we suggest choosing a more rectangular print size to accommodate the width of the stage. See Examples Below.



8 X 18



8 X 10

For onstage posed photos at conventions we recommend making sure you practice your final onstage pose to make sure that everyone's faces can be seen, as our photographer will not be able to direct the group. These photos are taken at the end of your performance during the applause and are taken automatically without any direction from the photographer.

## SHIPPING

Orders will be shipped to the address specified on the first page

## US SHIPPING

-Flat Rate-  
\$10

## AMOUNT DUE & PAYMENT

*Read Photography*

1800 42nd St. NE  
Cedar Rapids, IA 52402  
(319) 393-0547

val@readphotography.com  
www.readphotography.com

Credit Card # \_\_\_\_\_

Sec. Code \_\_\_\_\_

Zip Code \_\_\_\_\_

Exp. Date \_\_\_\_\_

## PACKAGE SUBTOTAL:

## INDIVIDUAL PHOTO SUBTOTAL:

## PR IMAGE SUBTOTAL:

## SHIPPING:

## TOTAL AMOUNT DUE:

**DEADLINE: April 1, 2020**

## Open Division Information

- Open Division is open to choruses and quartets.
- There is not a different registration fee for the Open Division. All competition registration fees are the same (chorus: \$150; quartet: \$100).
- Competitors have 10 minutes to complete their Open Division packages.
- Competing in the Open Division meets the 3-year competition requirement for choruses.
- Riser configurations will not change due to Open Division. There will still be either standard or alternate.
- It is the region's choice to allow both riser configurations; it is also their choice to decide which configuration is offered first.
- The drawing for regional competitions will be as follows:
  - o Quartets: Evaluation Only, International Division, Open Division
  - o Choruses:
    - One riser configuration: Evaluation Only, International Division, Open Division
- Directors with dual memberships who sing and direct two different choruses in the same contest will be taken into consideration for the order of appearance draws.
- Timing starts at the first word spoken or sung. Excessive time spent entering the stage can result in a delay of contest penalty.
- Competitors will use the same lighting and staging options that are available to the International Division competitors, i.e. no pyro techniques or electricity will be allowed on stage.
- Competitors may not change from International Division to Open Division (or vice versa) after the first draw for order of appearance has been conducted at HQ.
- Competitors wishing to qualify for Harmony Classic or International Competition must compete in the International Division. Competitors cannot qualify for Harmony Classic or International if they compete in Open Division.
- Competitors cannot enter both the International Division and the Open Division of the same contest.
- The same song choice limitations apply to the contest songs as there have always been: no patriotic, religious or Sweet Adelines International songs may be sung as contest songs.
- Open Division provides competitors with the opportunity to present a "show performance" that is enhanced by the educational experience gained through official scoresheets. It is for evaluation only and thus receives a letter score.
- If a competitor is disqualified from the Open Division, they are not eligible for the Audience Choice Award.
- Only competitors entering the Open Division qualify for the Audience Choice Award.
- Competitors competing at International in the current year and performing in Open Division are not eligible for the Audience Choice Award.
- If there is only one quartet or chorus competing in the Open Division, they will receive a Bravo Award. Audience Choice Award will only be awarded if there is 2 or more competitors in the Open Division.

Note: Open Division competitors will be in the random draw with International Division competitors. Evaluation Only competitors will still compete first in their respective riser configurations. If competing in the open Division, quartets and choruses must complete the cue forms (examples on page 23 (chorus) and page 24 (quartets) from the International e-packet and send or email to **Lyla Larson** **NO LATER than April 1, 2020**

**Lyla Larson**  
**971 Moonlight Drive**  
**Woodbury, MN 55125**  
**651-334-7105**

**Or email to: [Lylarson001@centurylink.net](mailto:Lylarson001@centurylink.net) by April 1, 2020**



## Regional CHORUS Open Division Cue Sheet

You <b>MUST</b> turn in a copy of this form to your region's Competition Coordinator <b>AT THE BRIEFING</b> . This form <b>MUST</b> be used. No other form will be accepted!	
Chorus Name:	Contestant #:

Note: Timing begins at the first word spoken or the first chord of the first song, whichever begins the performance, and continues through the final chord of the last song or the last word spoken, whichever concludes the performance. The prepared program must list all planned activity occurring on stage after completion of the entrance and following the official introduction. Planned activity occurring prior to the first word spoken or the first chord of the first song, whichever begins the performance, will result in disqualification if in the opinion of the panel chair and a majority of judges on the panel the time spent is excessive and results in a delay of the contest.

PLEASE USE LAYMAN'S TERMS; DON'T USE A CUE INDICATING THE NUMBER OF MEASURES INTO A SONG

	OPTIONAL LIGHTING	MICROPHONES	EMCEE WORK	CHOREOGRAPHY
<p>List song titles and check <b>all</b> boxes that apply. If a medley is used, list <b>ALL</b> songs included in the medley.</p> <p>Please check which song is to be judged as your <b>1st</b> song.</p>	<p>*White is used during the first song, combined with the other colors.</p> <p>*If available from region.</p>	<p>Indicate mic(s) used for each song. * Center stage is fixed in the quarter configuration.</p>	<p>Briefly indicate whether emcee work occurs before, during or after the song.</p>	<p>Briefly describe any special moves, indicating location on stage.</p>
<p>SONG TITLE:</p>	<p>Check all that apply</p> <p><input type="checkbox"/> Stage Left</p> <p><input type="checkbox"/> Center</p>	<p><input type="checkbox"/> Stage Left</p> <p><input type="checkbox"/> Center</p>	<p><input type="checkbox"/> Stage Left</p> <p><input type="checkbox"/> Center</p>	<p>This song is: <input type="checkbox"/> Ballad <input type="checkbox"/> Uptune</p>
<p>Contest Song? <input type="checkbox"/> Yes <input type="checkbox"/> No</p>				
<p>SONG TITLE:</p>	<p>Check all that apply</p> <p><input type="checkbox"/> Stage Left</p> <p><input type="checkbox"/> Center</p> <p><input type="checkbox"/> Stage Right</p>	<p><input type="checkbox"/> Stage Left</p> <p><input type="checkbox"/> Center</p> <p><input type="checkbox"/> Stage Right</p>	<p><input type="checkbox"/> Stage Left</p> <p><input type="checkbox"/> Center</p> <p><input type="checkbox"/> Stage Right</p>	<p>This song is: <input type="checkbox"/> Ballad <input type="checkbox"/> Uptune</p>
<p>Contest Song? <input type="checkbox"/> Yes <input type="checkbox"/> No</p>				
<p>SONG TITLE:</p>	<p>Check all that apply</p> <p><input type="checkbox"/> Stage Left</p> <p><input type="checkbox"/> Center</p> <p><input type="checkbox"/> Stage Right</p>	<p><input type="checkbox"/> Stage Left</p> <p><input type="checkbox"/> Center</p> <p><input type="checkbox"/> Stage Right</p>	<p><input type="checkbox"/> Stage Left</p> <p><input type="checkbox"/> Center</p> <p><input type="checkbox"/> Stage Right</p>	<p>This song is: <input type="checkbox"/> Ballad <input type="checkbox"/> Uptune</p>
<p>Contest Song? <input type="checkbox"/> Yes <input type="checkbox"/> No</p>				
<p>Is your package starting with spoken word? <input type="checkbox"/> Yes <input type="checkbox"/> No</p>	<p>Is your package ending with spoken word? <input type="checkbox"/> Yes <input type="checkbox"/> No</p>			

## Regional CHORUS Open Division Cue Sheet

You MUST turn in a copy of this form to your region's Competition Coordinator AT THE BRIEFING. This form MUST be used. No other form will be accepted!	
Chorus Name:	Contestant #:

Note: Timing begins at the first word spoken or the first chord of the first song, whichever begins the performance, and continues through the final chord of the last song or the last word spoken, whichever concludes the performance. The prepared program must list all planned activity occurring on stage after completion of the entrance and following the official introduction. Planned activity occurring prior to the first word spoken or the first chord of the first song, whichever begins the performance, will result in disqualification if in the opinion of the panel chair and a majority of judges on the panel the time spent is excessive and results in a delay of the contest.

PLEASE USE LAYMAN'S TERMS; DON'T USE A CUE INDICATING THE NUMBER OF MEASURES INTO A SONG

	LIGHTING	MICROPHONES	EMCEE WORK	CHOREOGRAPHY
List song titles and check <b>all</b> boxes that apply. If a song is used, list <b>ALL</b> songs included in the medley. Please check which song is to be judged as your contest song.	Used during contest <input type="checkbox"/> Blue <input type="checkbox"/> Red <input type="checkbox"/> Other	Indicate mic(s) used for each song. * Center stage is fixed in the quartet configuration. *If available from region.	Briefly indicate whether emcee work occurs before, during or after the song.	Briefly describe any special moves, indicating location on stage.
SONG TITLE:		all that apply <input type="checkbox"/>		
Contest Song? <input type="checkbox"/> Yes <input type="checkbox"/> No				This song is: <input type="checkbox"/> Uptune <input type="checkbox"/> Ballad
SONG TITLE:		all that apply <input type="checkbox"/>		
Contest Song? <input type="checkbox"/> Yes <input type="checkbox"/> No		<input type="checkbox"/> Stage Left <input type="checkbox"/> Stage Center <input type="checkbox"/> Stage Right		This song is: <input type="checkbox"/> Uptune <input type="checkbox"/> Ballad
SONG TITLE:		Check all that apply <input type="checkbox"/> Stage Left <input type="checkbox"/> Stage Center <input type="checkbox"/> Stage Right		This song is: <input type="checkbox"/> Uptune <input type="checkbox"/> Ballad
Contest Song? <input type="checkbox"/> Yes <input type="checkbox"/> No				
Is your package starting with spoken word? <input type="checkbox"/> Yes <input type="checkbox"/> No				
Is your package ending with spoken word? <input type="checkbox"/> Yes <input type="checkbox"/> No				

# Regional Convention Committee

## **Competition Coordinator (CC)**

Shirley Christie  
P: 204-256-2265  
C: 204-794-2977  
smchris@shaw.ca

## **Assistant Competition Coordinator**

Pat Haertel  
P: 763-559-5877  
pphb3@comcast.net

## **Awards**

Lynda Reimer  
P: 612-866-7156  
theriemers49@comcast.net

## **Publications**

Linda Rubis  
H: 712.336.4765  
C: 712.320.4765  
lrubis07@Q.com

## **Event Coordinator**

### **Chairman of Region Convention (CRC)**

Lyla Larson  
651-334-7105  
Lylarson001@centurylink.net

## **Official Panel Liaison (OPL)**

Judi Peterson  
C: 715-377-5674  
judisings@somtel.net

## **Finance Coordinator**

Jerralyn Tjeerdsma  
605-366-4793  
jetjeerdsma@gmail.com

**Any competitor interested in posting their regional competition performance on YouTube, social media or their website must have Sweet Adelines International's permission before posting and sharing. Please email: Music Services ([music@sweetadelines.com](mailto:music@sweetadelines.com)) for permission.**





**New for 2020 – Rochester City and Historical Trolley Tour**

**\$35 per person - Must be booked in advance – See Region 6 website for booking details**

**Friday, May 8 - 1:30 – 5:00PM - Pick up at Hilton Hotel Downtown**

Join us on our vintage red trolleys for a narrated city tour featuring Rochester's top sites and attractions, including our Mayo historical sites! Explore the early years of the world-famous Mayo Clinic, while experiencing the homes and lives of pioneering doctors on this relaxing, entertaining and informative trolley tour! In addition to the trolley tour you will explore either Mayowood Mansion or Assisi Heights on a walking tour.



# HIGHLIGHTS!

---

- ✓ **Mayo Clinic Campus** ~ Largest Clinic of Its Kind In the World
- ✓ **Downtown Rochester & Peace Plaza** ~ Cosmopolitan Shops, Restaurants, & Plazas
- ✓ **Plummer Building** ~ Original Mayo Clinic Building Designed by Dr. Henry S. Plummer
- ✓ **Mayo Civic Center & Rochester Art Center** ~ Largest Event Space in Southern MN with Beautiful Glass Atrium & Contemporary Architecture
- ✓ **Silver Lake Park** ~ Charming Lake District Featuring Limestone Arch Bridges
- ✓ **Assisi Heights** ~ Home of the Rochester Franciscan Community, Founders of St. Marys Hospital
- ✓ **St. Marys Hospital Campus & Chapel** ~ Among the Largest Private Hospitals In the Country, Rich In History
- ✓ **History Center of Olmsted County & Historic Stoppel Pioneer Farm** ~ Fascinating Sites that Depict the Area's Pioneer & Settlement Eras
- ✓ **Mayowood Historic Corridor** ~ Dr. Charlie's Limestone Carriage Barn & Stables, Greenhouses, Cottages, River Bridge, Dam & Lake
- ✓ **Historic Mayowood Mansion** ~ Former Home of Mayo Clinic Co-Founder Dr. Charlie Mayo, Completed In 1911
- ✓ **Plummer House** ~ Former Home of Dr. Henry S. Plummer, Designer of Original Mayo Clinic Buildings
- ✓ **"Pill Hill" National Historic Residential District** ~ Historic Homes Built by Pioneering Doctors & Prominent Citizens
- ✓ **Mayo Foundation House** ~ Former Home of Mayo Clinic Co-Founder Dr. Will Mayo, Completed In 1918
- ✓ **Soldier's Field Veterans Memorial** ~ One of the Finest Memorials In the Country
- ✓ **Calvary Episcopal Church** ~ Mayo Family Church & Oldest Church in Rochester
- ✓ **Feith Family Statuary** ~ Park Honoring Founders of Mayo Clinic & Saint Marys Hospital

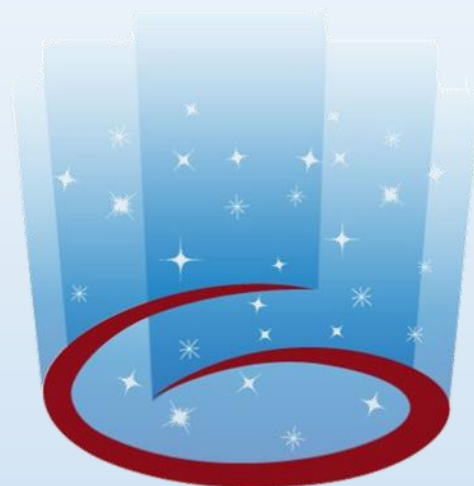

**NORTHERN  
LIGHTS**  
*Region 6*



***Sweet Adelines***  
**INTERNATIONAL**  
*Life on a High Note.*

***Celebrating 75 Years of Harmony***